



**PN 10/16 - DN 80**

KAT-A 1644

**Product characteristics and benefits**

- With flange end acc. to EN 1092-2 BS10 Table D/E
- Automatic draining system and pressurized water protection (closed during operation of the hydrant)
- Low operating torque
- Replacement of the shaft seal possible under pressure
- Outlet with 2 1/2" London round thread outlet

**Materials**

- Body: Ductile cast iron EN-JS 1030 (GGG-40), BS 2789 quality grade 420/12
- Valve cone: Ductile cast iron EN-JS 1030 (GGG-40) all around EPDM vulcanized
- Outlet: Copper alloy (CC767S to EN 1982)
- Stem: Stainless steel 1.4021
- Bolts: A2 (DIN EN ISO 3506)

**Corrosion protection**

- Inside and outside epoxy coating

**Field of Application**

- Underground installation



**Tests and approvals**

- Final inspection test acc. to EN 12266 (DIN 3230 Part 4)
- Elastomers approved acc. to WRC
- WRAS tested and registered

**Note**

This hydrant is a Type 2a hydrant acc. to BS 750. If installed underground, no maintenance work is possible.

For proper installation and safe operation please follow the installation and operation instructions:  
KAT-B 1644 BSH

**Field of application**

DN	PN	Maximum operating pressure [bar]	Maximum operating temperature for neutral liquids [°C]
80	16	16	50
80	10	16	50

**Pressure test acc. to EN 12266**

Test pressure body with water [bar]	Test pressure seat with water [bar]
24	18
24	18

Drawing

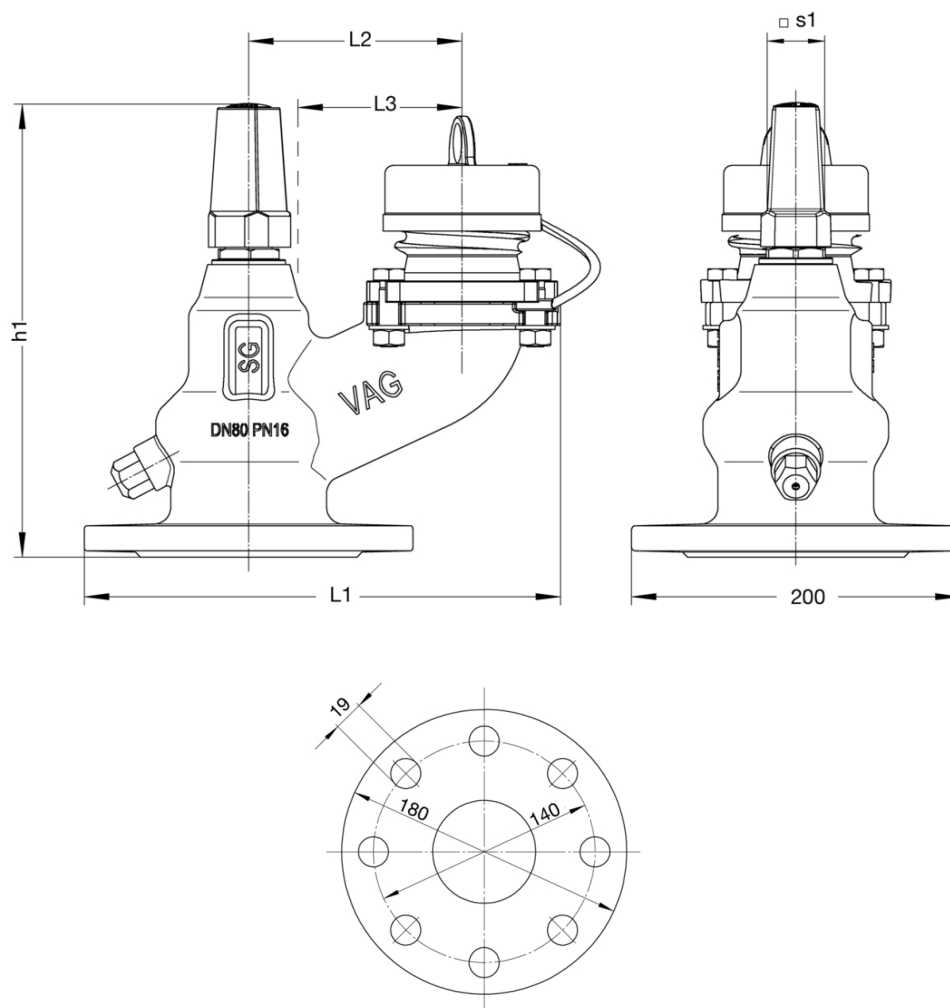

Technical data

PN 16

<b>DN</b>		<b>80</b>
L1	[mm]	290
L2	[mm]	130
L3	[mm]	100
h1	[mm]	276
□ s1	[mm]	35
Weight approx.	[kg]	17.00
Volume approx.	[m <sup>3</sup> ]	0.016

PN 10

<b>DN</b>		<b>80</b>
L1	[mm]	290
L2	[mm]	130
L3	[mm]	100
h1	[mm]	276
□ s1	[mm]	35
Weight approx.	[kg]	17.00
Volume approx.	[m <sup>3</sup> ]	0.016